

Industrial Panel Meters-Phenolic



635 - D.C Moving Coil
636 - A.C. Repulsion



597 - D.C Moving Coil
598 - A.C. Repulsion

DIMENSIONS:

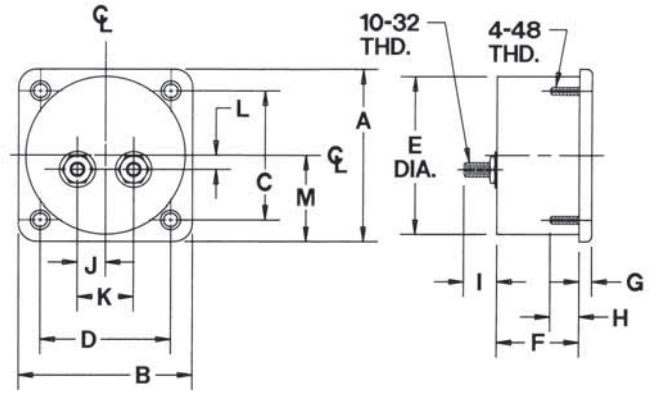

2-1/2 & 3"

MODELS	A	B	C	D	E	F	G	H	I	J	K	L	M
635/636	2.38	2.38	1.88	1.88	2.20	1.40	0.20	0.55	0.50	0.48	0.97	0.00	1.19
597/598	3.00	3.00	2.25	2.25	2.75	1.42	0.22	0.50	0.50	0.48	0.97	0.25	1.50



680 - D.C Moving Coil
681 - A.C. Repulsion



647 - D.C Moving Coil
648 - A.C. Repulsion

DIMENSIONS:

4-1/2"

